

13601 / 13602 Printer Instructions

Printer Setup



Inside the printer box you will find:

- 1 Printer (Reichert catalog number 13601 110V / 13602 220V)
- 1 AC/DC power adapter
- 1 Data cable
- 1 RS232 male / female gender changer
- 1 Spare paper roll

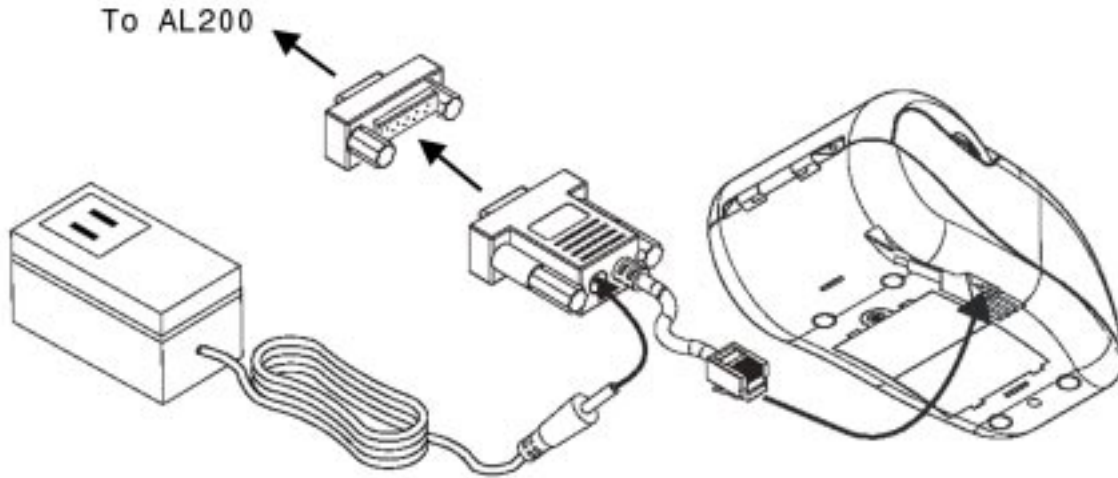

1. Insert the RS232 male / female gender changer into the RS232 data port on the back of the AL200. Tighten the screws.
2. Plug the “phone-style” connector of the data cable into the receptacle on the bottom side of the printer. Route the cable neatly through the guide channel
3. Take hold of the other end of the data cable (RS232 end). Insert the cylindrical plug of the AC/DC power adapter into the receptacle on the back of the RS232 connector on the data cable.
4. Insert the RS232 end of the data cable into the RS232 gender changer on the back of the AL200
5. Plug the AC/DC power adapter into a wall outlet of the correct voltage

Installing New Printer Paper

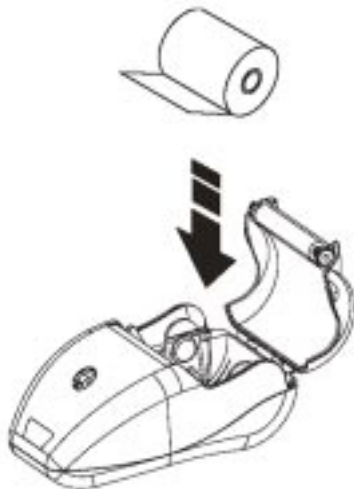

1. Open the cover of the AL200 printer
2. Remove the empty spindle from the expired paper roll
3. Insert the new paper roll directly into the printer as shown in the accompanying illustration. The paper roll will “click” into place when fully inserted. Insure that the end of the paper extends above the body of the printer.
4. Close the cover.